



NICOMATIC France is certified ISO 9001 :2000

CRIMPFLEX® 1,27mm pitch

NEW 2009

NICOMATIC is now enriching the **CRIMPFLEX®** connector range to provide even **more space and cost-savings solutions** thanks to the **1,27 mm pitch**. Our specifically designed **Crimping Press** allows you to crimp up to 25 contacts in a single operation in order to **increase your productivity and eliminate any risk of pitch drift** during the crimping process.

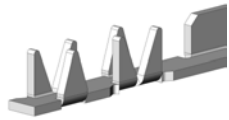

The contact crimping is achieved by piercing the conductor in 6 points, in order to ensure both outstanding **mechanical retention** by 2 points and **electrical continuity** by 4 points.
 CRIMPFLEX® system patented by NICOMATIC

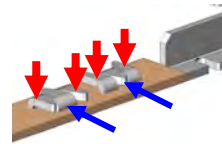

Crimp Pad Design :
 please turn the page

FEMALE CONTACT P/N 16068

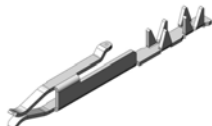

16068-12 tin plated
 16068-32 selective gold

- for 0,38mm (.0015") to 0,45mm (.0018") pin header
- Ni 2µ + Sn 5µ and optional selective Au plating 0,15µ on mating area



PACKAGED IN REEL

MALE SOLDER TAB P/N 16069



16069-12 tin plated

- recommended for flexible supports requiring male solder tabs
- Ni 2µ + Sn 5µ

1 ROW

HOUSING SERIES xx = number of ways

2 ROWS

M0Fxx



- Side to side & end to end stackable
- No Polarization nor locking

M0Jxx

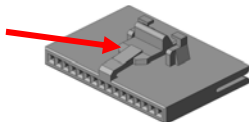

- Easy mating/unmating to walled pinheaders
- Locking by **latch**

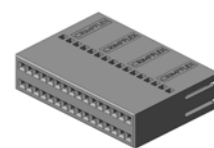

M4Fxx

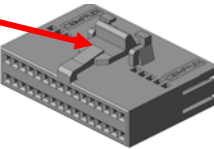

M4Jxx

M0JRxx

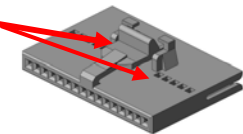

- Idem M0J type
- Reverse **latch position**

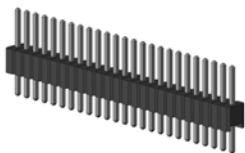

straight male header
 12-17-11M-xx-1

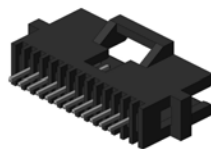

straight male socket
 1L-10-11M-xx-1

available in single & double row, straight & 90°PCB tin & gold plated contacts

SPECIFICATIONS

- **MATERIAL**
 Contacts : phosphor bronze
 Housings : glass fiber filled thermoplastic
- **MECHANICAL**
 Max. insertion force per contact : 1 N
 Min. withdrawal force per contact : 0,15 N
 Crimp strength to flexcable per contact: 50N min.
- **ELECTRICAL**
 Dielectric withstanding voltage : 900V RMS
 Rated voltage : 300V RMS
 Rated / peak current per contact : 3A / 4A RMS
 Initial contact resistance: 10m Ω
- **THERMAL**
 UL 94-V0 classified
 -55°C to + 150°C operating temperature range





CRIMPFLEX® 1,27mm Flexcable Jumpers

NEW 2009

Part-Numbering system

cable specs left end right end

127 PW 14 D 0305 - S1 $\begin{pmatrix} B \\ K \\ C \\ W \end{pmatrix}$ **F2H** $\begin{pmatrix} B \\ K \\ C \\ W \end{pmatrix}$ **(R)**

- **Pitch** 1,27mm
- **Style** Standard white polyester
- **Number of conductors** from 4 to 100 with housings
- **Conductor size** 0,076mm thickness x 0,66mm width
- **Connection length in mm**

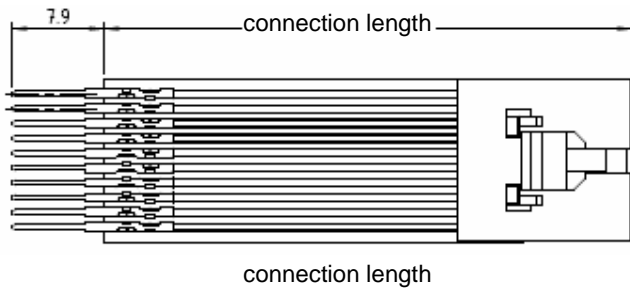

CONNECTOR STYLE for both left & right ends

- 1st item = CONTACT TYPE
 S1 for solder tab 16069-12
 F1 for female contact 16068-12
 F2 for female contact 16068-32
- 2nd item = HOUSING
 blank for no housing
 H for M0Fxx
 J for M0Jxx
 T for M0JRxx
 4 for M4Fxx
 M for M4Jxx
- OPTIONS
 B = bending to the crimping side
 C = bending to the crimping opposite side
 K = polyimide insulator (solder tab only)
 W = polyester insulator (solder tab only)
 R = left/right crimping at opposite sides

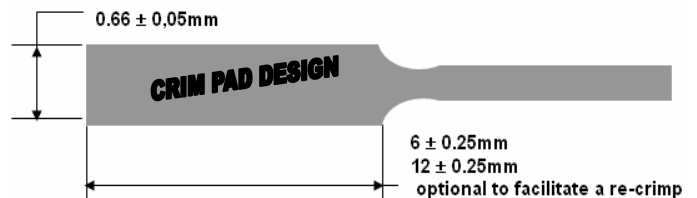
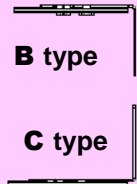

1.27mm FLEXCABLE SPECS

- **MATERIAL & SIZE**
 Tinned copper conductors
 Insulator thickness: 0,05 mm x 2
- **ELECTRICAL**
 Operating voltage: 300 V RMS
 Dielectric withstanding voltage: 1100V AC
 AC current rating per conductor: 3A
 Resistance: 105 Ω / km
- **MECHANICAL**
 Flex life: > 10 M.cycles at 25mm bend radius
- **THERMAL**
 UL flame rating VW-1
 -55°C to + 105°C operating temperature range



March 2009 - non contractual document – NICOMATIC reserves the right to discontinue the production or to change the specifications of any part of this data sheet without prior notice - ©



Vertrieb durch:



DICO Electronic GmbH & Co KG
 Ständlerstraße 37 · 81549 München
 Telefon 089-92334499-0 · Telefax 089-92334499-9
 info@dico-electronic.de · www.dico-electronic.de