

Rack & Panel

JF Series

Miniature Side Mount / #20 Contacts / .040" Dia. / 7.5 Amps

OUTLINE

Dimensions are for reference only and are subject to change. Outline drawings on request.

Side Mounting, 4 Position Rectangular 2 and 4 Position In-Line

JF Series, PIN and Socket, 2 Position In-Line Connectors

Dimensions shown are typical for all standard 2 position in-line connectors.

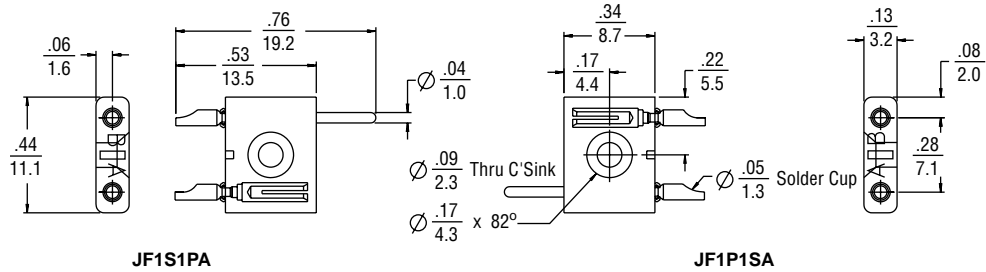

JF1S1PA

JF1P1SA

JF Series, PIN and Socket, 4 Position In-Line Connectors

Dimensions shown are typical for all standard 4 position in-line connectors.

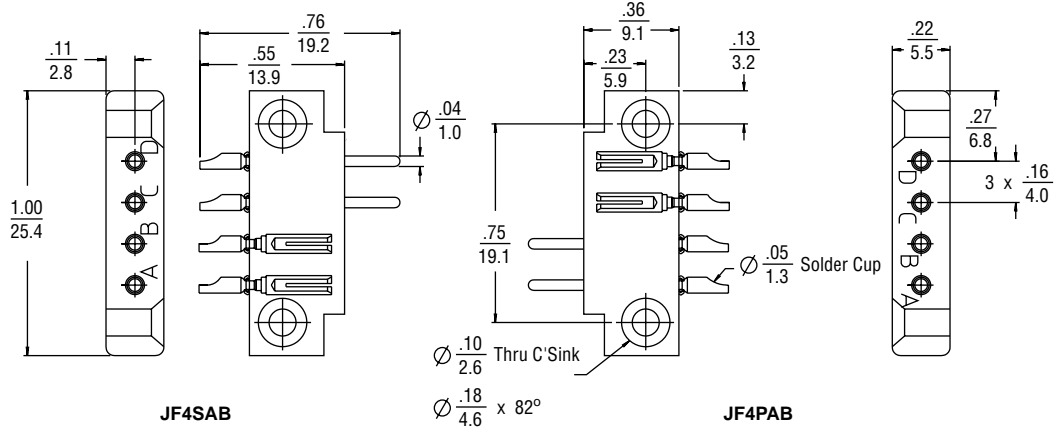

JF4SAB

JF4PAB

Side Mounting, 4 Position Rectangular, 2 and 4 Position In-Line

JF Series, PIN and Socket, 4 Position Rectangular Connectors

Dimensions shown are typical for all standard 4 position rectangular connectors.

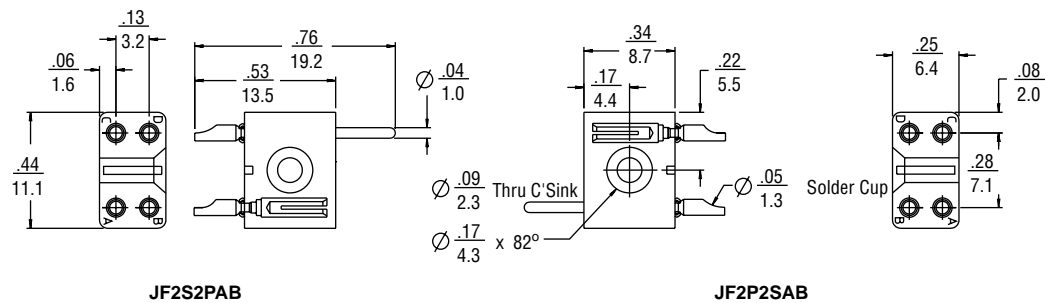

JF2S2PAB

JF2P2SAB

Rack & Panel

JF Series

Miniature Side Mount / #20 Contacts / .040" Dia. / 7.5 Amps

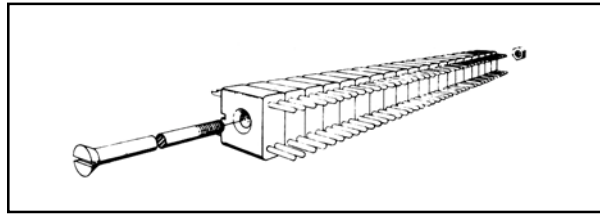

JF-2P
20 connectors assembled

The versatile JF Series has a countersunk mounting hole and narrow width permitting exceptionally flat mounting. Maximum circuit density is provided with many positive polarizations. "Custom" multi-contact connectors are readily available by using the building block technique shown above.

OUTLINE

Dimensions are for reference only and are subject to change. Outline drawings on request.

Typical Connector With DIP Solder Termination

JF Series connectors may be ordered with dip solder and right angle terminations. Consult factory for availability.

Straight Dip Solder

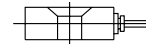

Right Angle Dip Solder

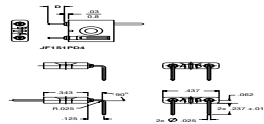
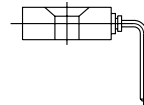

Typical Connectors Assemblies

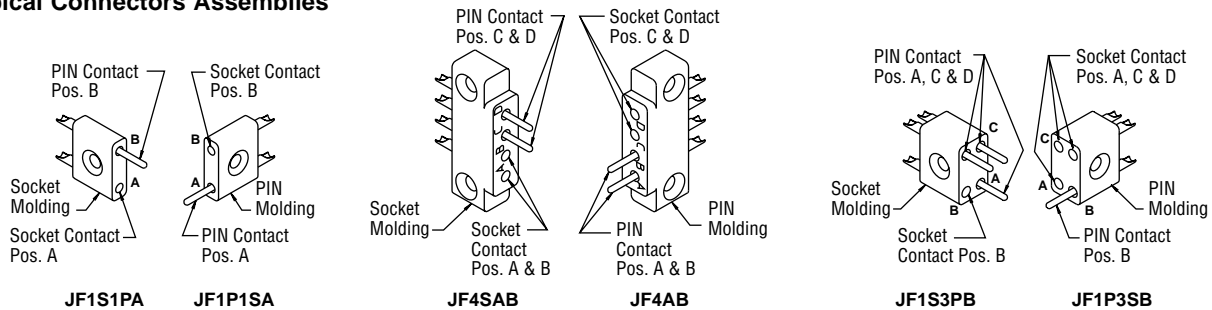

Winchester/Retconn

400 Park Road ■ Watertown, Connecticut 06795-0500 ■ Phone: (860) 945-5000 ■ FAX: (860) 945-5191 ■ Internet: <http://www.litton-wed.com>

ORDERING INFORMATION

2 Position In-Line Connector

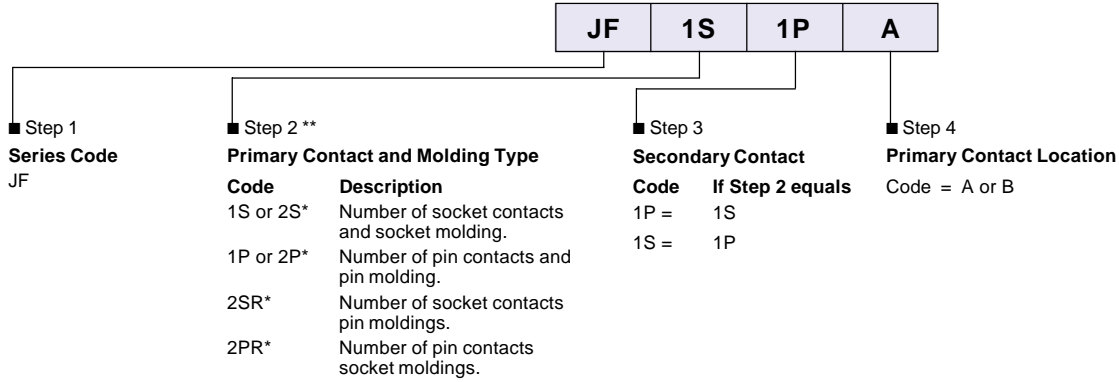

*For two same type contacts, skip Steps 3 & 4.

4 Position In-Line Connectors

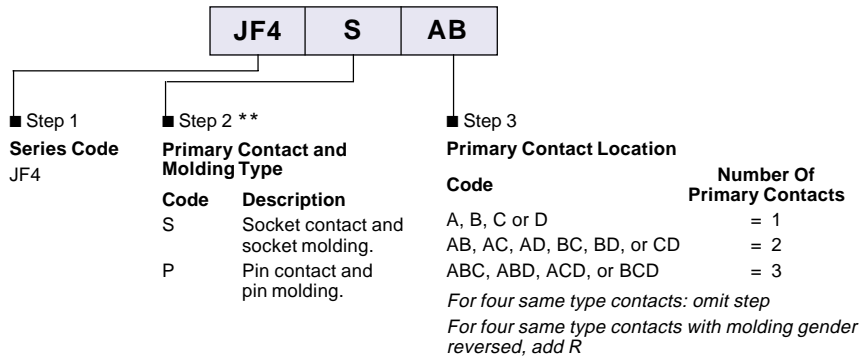

4 Position Rectangular Connector

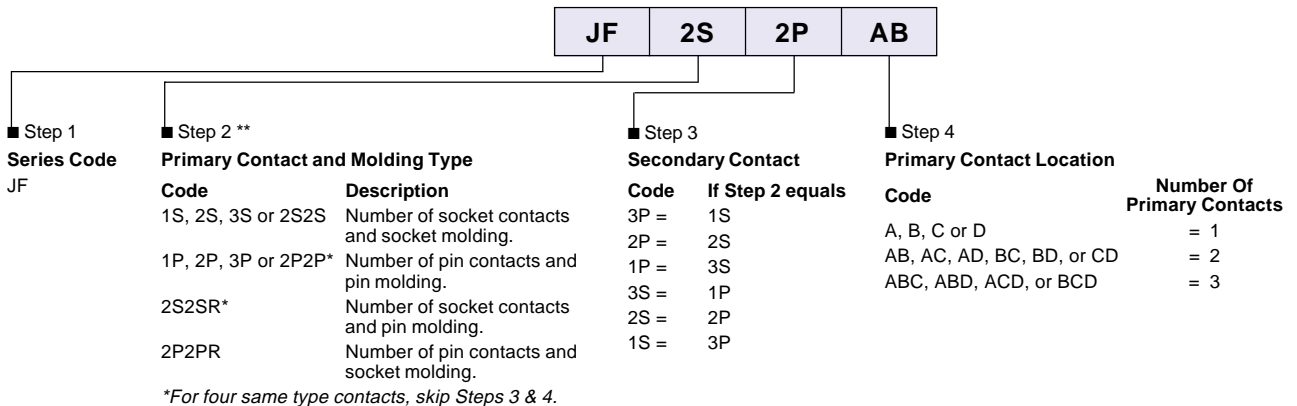

*For four same type contacts, skip Steps 3 & 4.

**For Pictorial Presentation, see RP/84 and RP/85

SPECIFICATIONS

Materials

Moldings (PIN and Socket): Diallyl Orthophthalate
Pin Contacts: .040 Brass, gold plated
Socket Contacts: Phosphor bronze, gold plated

Performance Characteristics

Dielectric Withstanding Voltage: 1500 VAC (at sea level)
Current Rating: 7.5 Amps
Operating Temperature Range: -55°C to +125°C
Termination Type: .050 dia. solder cup to accept #20 AWG stranded wire.

Rack & Panel

JFA Series

Miniature Side Mount / #16 Contacts / .062" Dia. / 13 Amps

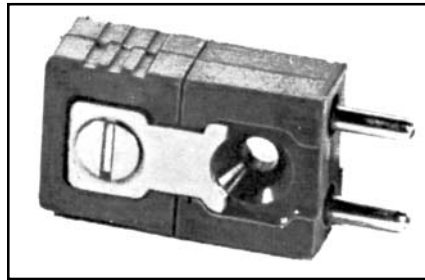

JFA2H — JFA2P
Hood and plug

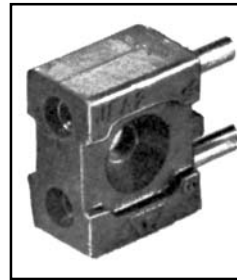

JFA2S
Receptacle

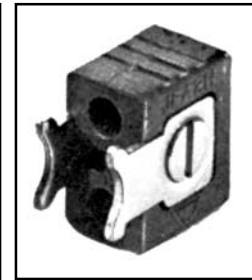

JFA2H
Hood

For applications in electronic and communications equipment requiring miniature connectors with high current capacity. Series JFA miniature connectors may be used in television, radio and communications

equipment. The countersunk side mounting hole and narrow width permits exceptionally flat mounting —thereby minimizing connector protrusion when installed on equipment

SPECIFICATIONS

Current Rating: 13 amps

No. of Contacts: 2

Pin Contacts: .062 dia. brass, gold plated

Socket

Contacts: Phosphor bronze, gold plated

Terminations: .070 dia. solder cup will accept up to #16 AWG stranded wire.

Electrical Data: Dielectric withstanding voltage is one minute electrification at 2925 VAC.

Dielectric: Molded diallyl phthalate per MIL-M-14

Hood: Locked to connector by means of two side mounted straps.

OUTLINE

Dimensions are for reference only and are subject to change. Outline drawings on request.

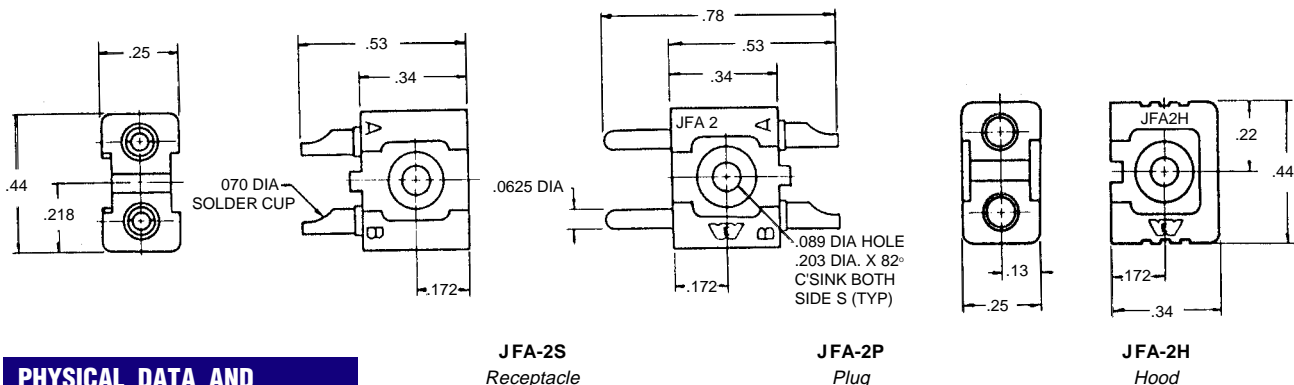

PHYSICAL DATA AND ORDERING INFORMATION

Physical Data

Code Number	Number of Contacts	Current Rating Amps	Wire Size A.W.G.	Weight Ozs.
JFA-1P1S	1 Pin 1 Socket	13	# 16	.082
JFA-2PH JFA-2SH (with hoods)	2 Pins 2 Sockets			.059 .046
JFA-1S1P	1 Pin 1 Socket	13	# 16	.082
JFA-2P JFA-2S (no-straps-on hoods)	2 Pins 2 Sockets			.059 .046

Mating Combinations

JFA2P	mates with	JFA2S
JFA2PH	mates with	JFA2SH
JFA1P1S-A	mates with	JFA1S1P-A
JFA1P1S-B	mates with	JFA1S1P-B
JFA1P1SH-A	mates with	JFA1S1PH-A
JFA1P1SH-B	mates with	JFA1S1PH-B

JFA2H — Hood — used on any of above 3 parts

Winchester/Retconn

400 Park Road ■ Watertown, Connecticut 06795-0500 ■ Phone: (860) 945-5000 ■ FAX: (860) 945-5191 ■ Internet: <http://www.litton-wed.com>